

Public Service Areas within the City of Knoxville

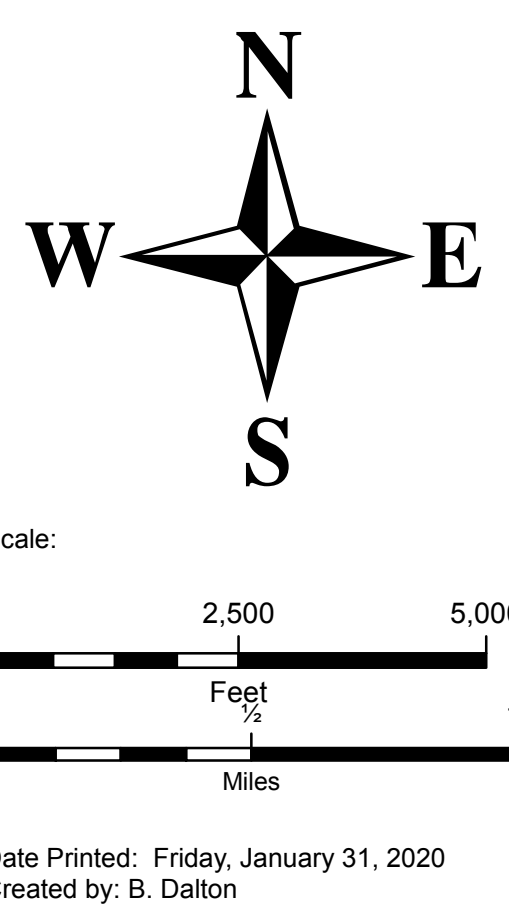

MAP DATA TAKEN FROM
AERIAL SURVEY OF KNOXVILLE
AND KNOX COUNTY. THIS MAP IS
INTENDED TO MEET NATIONAL MAP
ACCURACY STANDARDS AT THE
COMPLETION SCALE

DISCLAIMER
This map product was prepared from a Geographic Information System (GIS) data provided by the City of Knoxville, Knox County, and the Knoxville Utilities Board for their internal purposes only, and was not designed or intended for general use by members of the public. The KGIS Policy Board, its employees, agents and personnel, makes no representation or warranty as to its accuracy, and in particular, as accuracy as to labeling, dimensions, contours, property boundaries, or placement or location of any map features thereon. The KGIS Policy Board, its employees, agents and personnel, MAKES NO WARRANTY OF MERCHANTABILITY OR WARRANTY FOR FITNESS OF USE FOR A PARTICULAR PURPOSE. EXPRESS OR IMPLIED, WITH RESPECT TO THIS MAP PRODUCT. Any user of this map product accepts the same AS IS, WITH ALL FAULTS, and assumes all responsibility for the use thereof, and further covenants and agrees to hold personnel harmless from and against any damage, loss, or liability arising from any use of the map product.

Independent verification of all data contained on this map product should be obtained by any user of this map product. The KGIS Policy Board, its employees, agents and personnel, disclaims, and shall not be held liable for, any and all damage, loss or liability, whether direct, indirect or consequential which arises or may arise from this map product or the use thereof by any person or entity.

This map product has been copyrighted by the KGIS Policy Board. The KGIS Policy Board hereby reserves all rights thereto, and neither this map product, nor any portion thereof, may be reproduced in any form or by any means without the express written authorization of KGIS Policy Board or its agents.

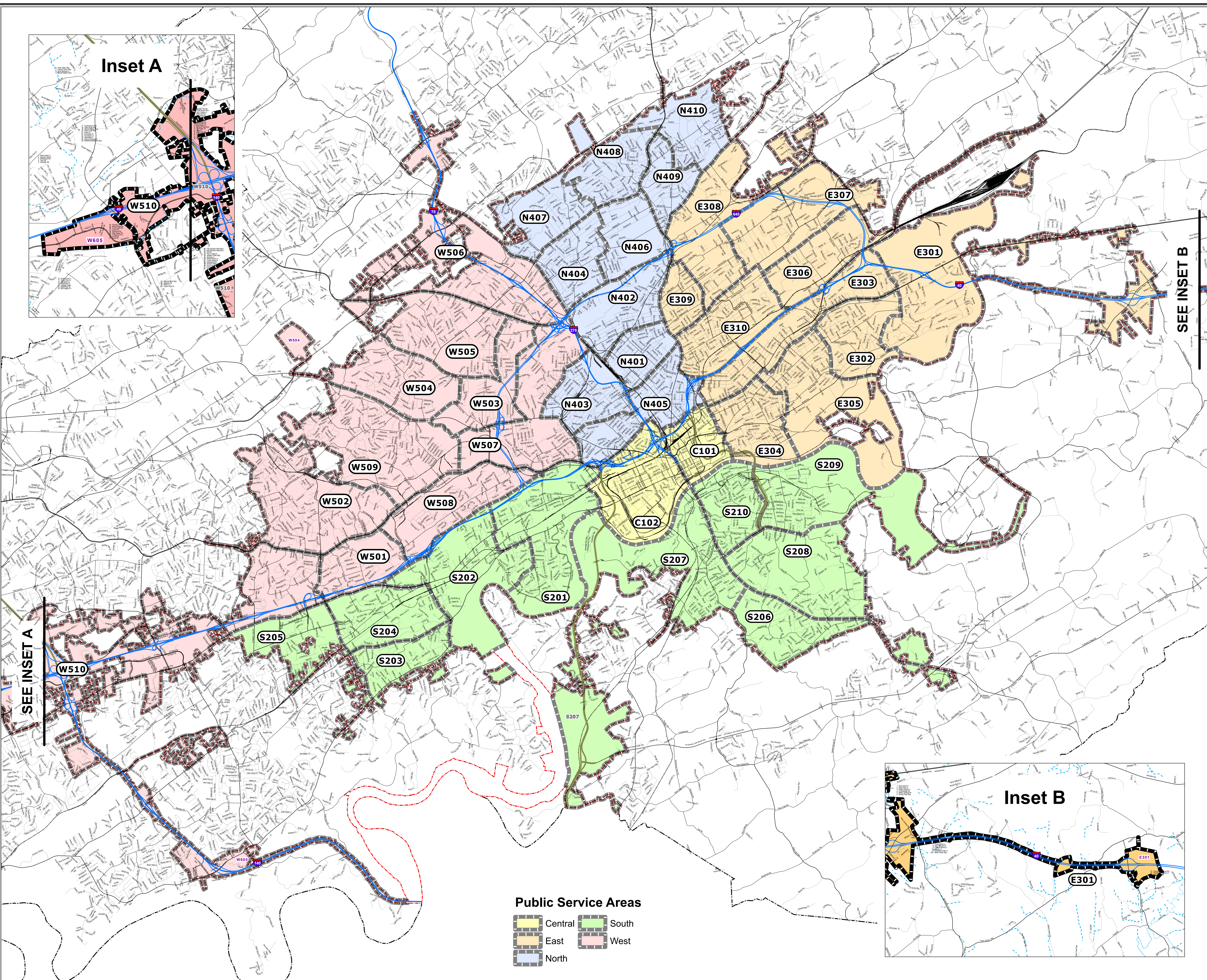
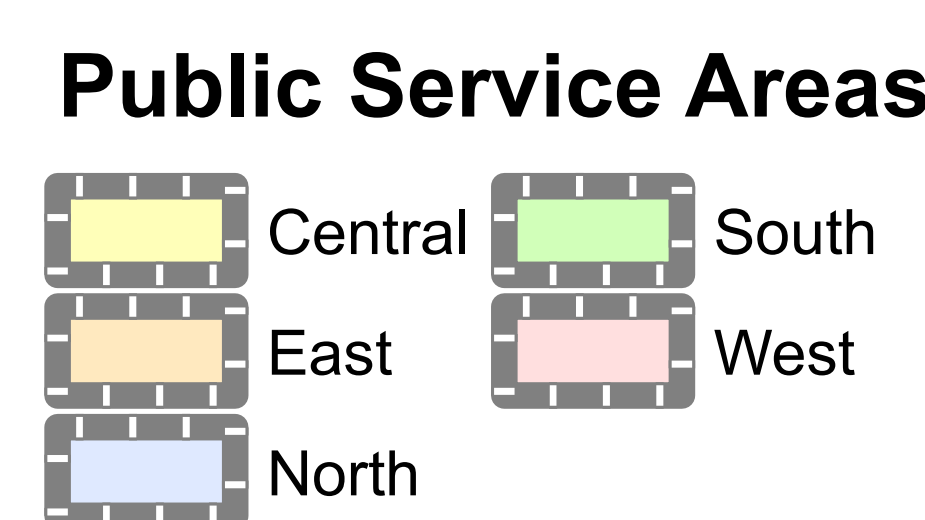
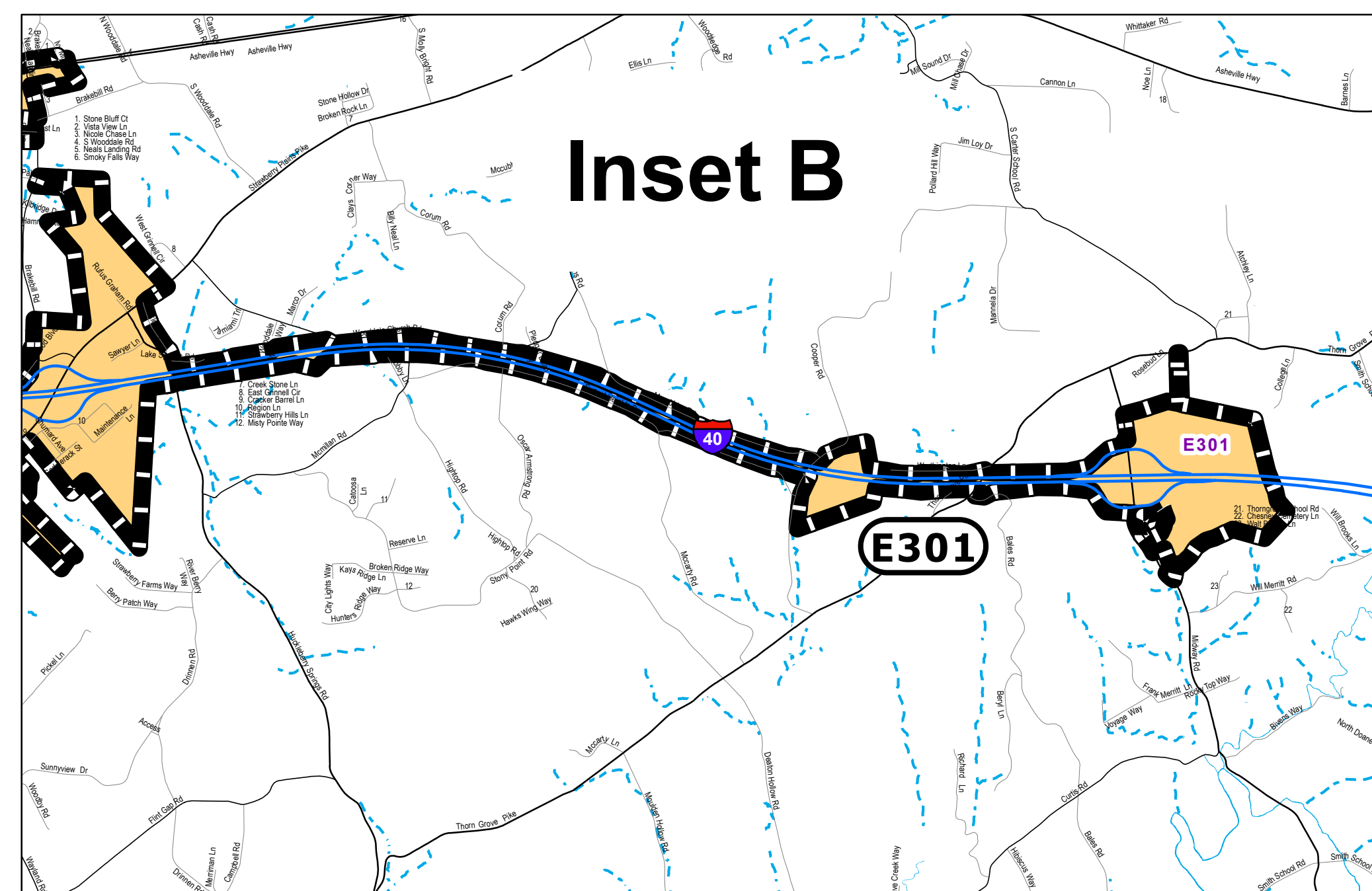
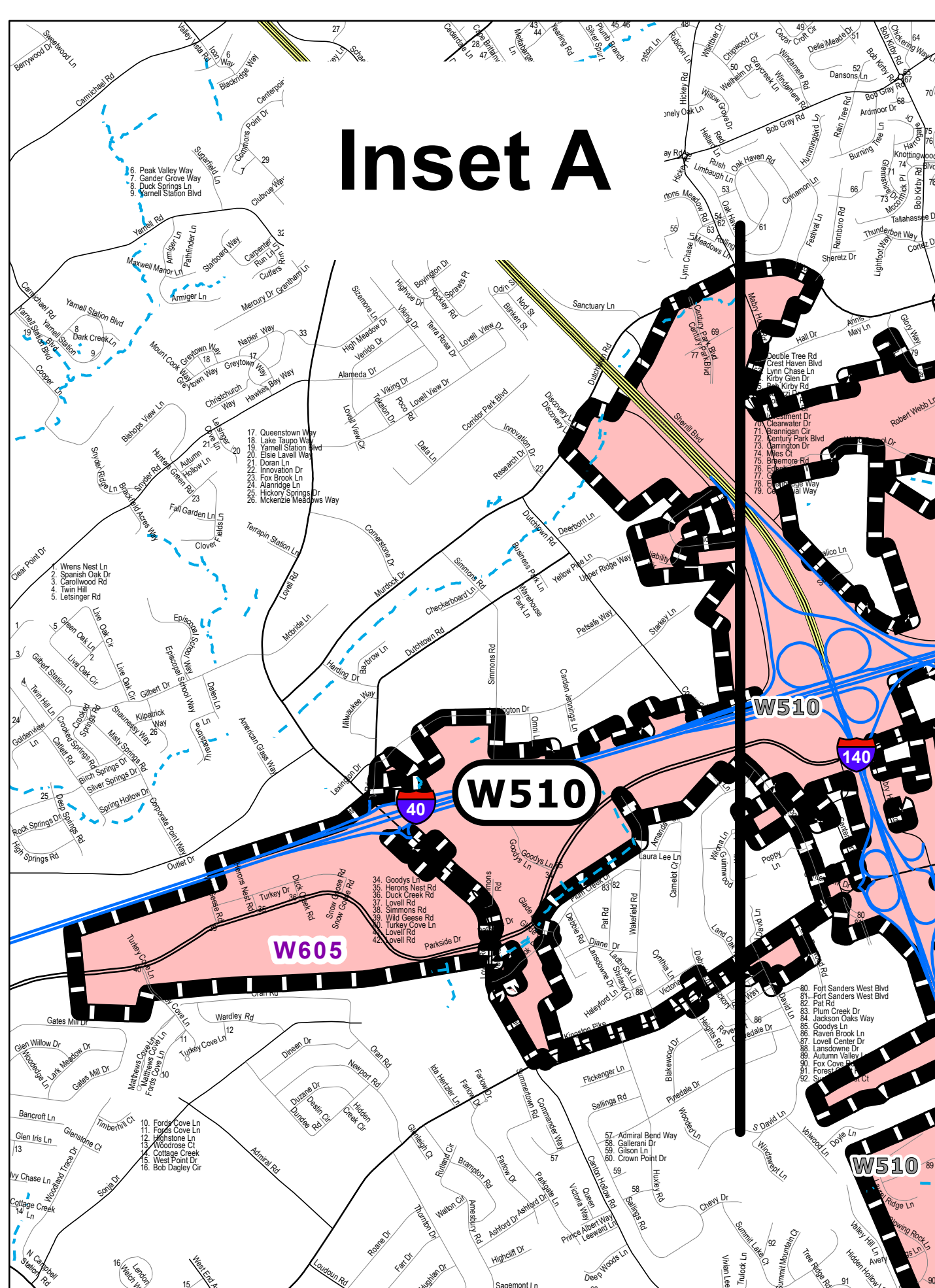

SEE INSET A

SEE INSET B