



**KNOXVILLE
SOUTH WATERFRONT
PUBLIC IMPROVEMENTS**

KNOXVILLE, TENNESSEE
Lead Consultant

ASSOCIATES
118 WASHINGTON STREET
CAMBRIDGE, MA 02139
617.452.0000
617.452.0007
HANSW@AECOM.COM

Masterplan Overview/Urban Design
Chris Koger, Senior
Cambridge, MA 02138
Tel: 617.354.1315

Masterplan Overview/Transportation
Glenn Jackson
Orlando, FL 32801
Tel: 407.843.6552

Marine Engineering
Robert A. Noland
Raleigh, NC 27609
Tel: 919.781.4626

Lighting Design
Lynn Petersen
Cambridge, MA 02142
Tel: 617.354.4502

Landscape Architecture
Royal Foster
Knoxville, TN 37902
Tel: 865.837.1100

Benfield Riches
Knoxville, TN 37902
Tel: 865.837.7009

Civil Engineers
Carson & Cannon
Knoxville, TN 37922
Tel: 865.670.8555

Wilbur Smith
1100 Mason Street, Suite 200
Knoxville, TN 37902
Tel: 865.963.4300

**NOT FOR
CONSTRUCTION**

02 Final SD package	06.04.08
04 Draft SD package	12.21.07
07 In progress	11.13.07
08 In progress	10.23.07
09 In progress	10.23.07
09 In progress	09.24.07
02 In progress	07.23.07
02 In progress	07.17.07
07 In progress	06.12.07
Issue	Date

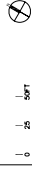

0 25 50 FT

JOB NO. HANSW 0701

Scale 1"=50'

Date 4 June 2008

Title SCHEMATIC DESIGN

PROJECT 2
GOOSE CREEK LANDING

Sheet No. P2L101

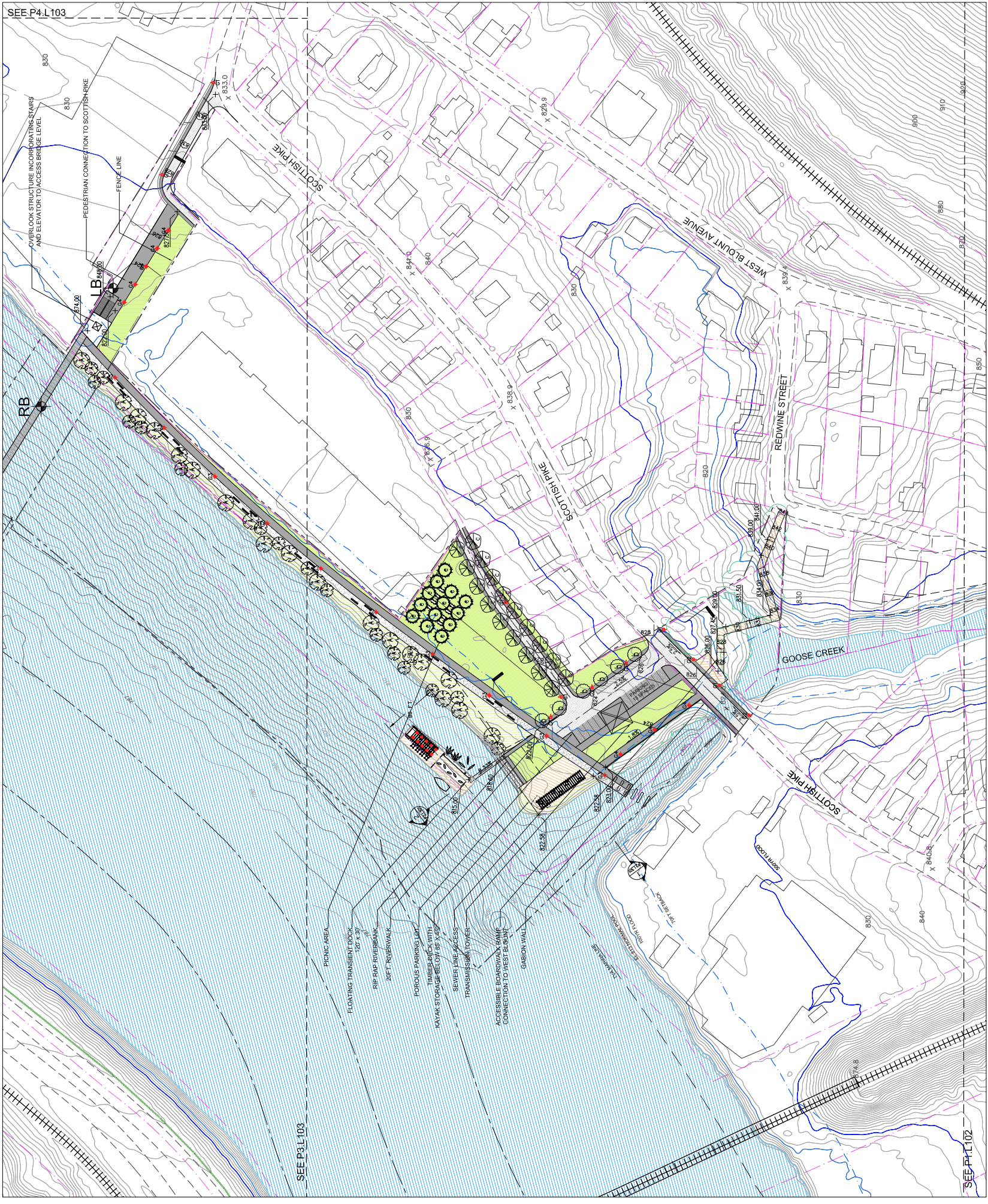

KNOXVILLE SOUTH WATERFRONT PUBLIC IMPROVEMENTS

ASSOCIATES
 1121 DICKSON AVE
 KNOXVILLE, TN 37902
 TEL: 615.557.1000
 FAX: 615.557.1001

MANAGER/PROJECT MANAGER
 Chan Krueger, S.E.
 8 Sherry Street, Suite 100
 Knoxville, TN 37902
 Tel: 615.554.1315

PROJECT MANAGER
 Claitor Jackson
 East Pine Street
 Knoxville, TN 37902
 Tel: 615.554.1315

MECHANICAL ENGINEERING
 Kufner & Nichol
 1818 East Memorial Street, Suite 100
 Knoxville, TN 37902
 Tel: 615.557.1000

LIGHTING DESIGN
 Lum Partners
 84 Sherman Street
 Knoxville, TN 37902
 Tel: 615.554.4522

LANDSCAPE ARCHITECTURE
 Reed/Fraser
 625 Gay Street
 Knoxville, TN 37902
 Tel: 615.557.1100

ARCHITECTURE
 Reed/Fraser
 515 Union Avenue
 Knoxville, TN 37902
 Tel: 615.557.1000

CIVIL ENGINEERS
 9724 Kingston Pike, Suite 110
 Knoxville, TN 37902
 Tel: 615.557.1000

WATERWAYS ENGINEERS
 Willow Smith Street, Suite 200
 Knoxville, TN 37902
 Tel: 615.553.4300

NOT FOR CONSTRUCTION

01	Final SD package	06.04.08
02	Final SD package	07.11.07
03	Final SD package	11.13.07
04	In progress	02.23.07
05	In progress	10.23.07
06	In progress	10.23.07
07	In progress	10.23.07
08	In progress	10.23.07
09	In progress	10.23.07
10	In progress	10.23.07
11	In progress	10.23.07
12	In progress	10.23.07
13	In progress	10.23.07
14	In progress	10.23.07
15	In progress	10.23.07
16	In progress	10.23.07
17	In progress	10.23.07
18	In progress	10.23.07
19	In progress	10.23.07
20	In progress	10.23.07
21	In progress	10.23.07
22	In progress	10.23.07
23	In progress	10.23.07
24	In progress	10.23.07
25	In progress	10.23.07
26	In progress	10.23.07
27	In progress	10.23.07
28	In progress	10.23.07
29	In progress	10.23.07
30	In progress	10.23.07
31	In progress	10.23.07
32	In progress	10.23.07
33	In progress	10.23.07
34	In progress	10.23.07
35	In progress	10.23.07
36	In progress	10.23.07
37	In progress	10.23.07
38	In progress	10.23.07
39	In progress	10.23.07
40	In progress	10.23.07
41	In progress	10.23.07
42	In progress	10.23.07
43	In progress	10.23.07
44	In progress	10.23.07
45	In progress	10.23.07
46	In progress	10.23.07
47	In progress	10.23.07
48	In progress	10.23.07
49	In progress	10.23.07
50	In progress	10.23.07
51	In progress	10.23.07
52	In progress	10.23.07
53	In progress	10.23.07
54	In progress	10.23.07
55	In progress	10.23.07
56	In progress	10.23.07
57	In progress	10.23.07
58	In progress	10.23.07
59	In progress	10.23.07
60	In progress	10.23.07
61	In progress	10.23.07
62	In progress	10.23.07
63	In progress	10.23.07
64	In progress	10.23.07
65	In progress	10.23.07
66	In progress	10.23.07
67	In progress	10.23.07
68	In progress	10.23.07
69	In progress	10.23.07
70	In progress	10.23.07
71	In progress	10.23.07
72	In progress	10.23.07
73	In progress	10.23.07
74	In progress	10.23.07
75	In progress	10.23.07
76	In progress	10.23.07
77	In progress	10.23.07
78	In progress	10.23.07
79	In progress	10.23.07
80	In progress	10.23.07
81	In progress	10.23.07
82	In progress	10.23.07
83	In progress	10.23.07
84	In progress	10.23.07
85	In progress	10.23.07
86	In progress	10.23.07
87	In progress	10.23.07
88	In progress	10.23.07
89	In progress	10.23.07
90	In progress	10.23.07
91	In progress	10.23.07
92	In progress	10.23.07
93	In progress	10.23.07
94	In progress	10.23.07
95	In progress	10.23.07
96	In progress	10.23.07
97	In progress	10.23.07
98	In progress	10.23.07
99	In progress	10.23.07
100	In progress	10.23.07

JOB NO.: HANSH 0701
 SCALE: 1"=50'
 DATE: 4 June 2008

THE SCHEMATIC DESIGN SITE LAYOUT PROJECT 2: GOOSE CREEK LANDING

Sheet No. **P2.L103**

KNOXVILLE
SOUTH WATERFRONT
PUBLIC IMPROVEMENTS

KNOXVILLE, TENNESSEE
 Lead Consultant



Masterplan Overview/Urban Design
 Chan Kieger-Sienkiewicz
 14 MASSING STREET
 CAMBRIDGE, MA 02138
 TEL: 617.354.5515

Masterplan Overview/Transportation
 Gusting Jackson
 14 MASSING STREET
 CAMBRIDGE, MA 02138
 TEL: 617.354.5515

Marine Engineering
 Mollitt & Nichol
 1000 WEST STREET, SUITE 160
 RALEIGH, NC 27609
 TEL: 919.781.4626

Lighting Design
 Lam Partners
 1000 WEST STREET, SUITE 160
 RALEIGH, NC 27609
 TEL: 919.781.4626

Landscape Architecture
 Ross Fowler
 1000 WEST STREET, SUITE 160
 RALEIGH, NC 27609
 TEL: 919.781.4626

Structural Engineering
 Broadfield Richens
 510 UNION AVENUE
 KNOXVILLE, TN 37902
 TEL: 865.637.7089

Civil Engineers
 Cannon & Cannon
 9724 MILDEN HALL SUITE 110
 KNOXVILLE, TN 37921
 TEL: 865.670.8555

Willard Smith
 1100 MARION STREET SUITE 200
 KNOXVILLE, TN 37901
 TEL: 865.562.5200

NOT FOR CONSTRUCTION

06 Final 50% release	08.04.08
08 Final 50% release	12.21.07
07 In progress	11.13.07
06 In progress	10.23.07
05 In progress	10.02.07
04 In progress	09.04.07
03 In progress	07.23.07
02 In progress	06.14.07
01 In progress	05.12.07
Issue	Date

Scale: 1" = 20'

Date: 4 June 2008

Title: SCHEMATIC DESIGN PROPOSED SECTIONS

PROJECT 2: GOOSE CREEK LANDING

Sheet No. P2.L301

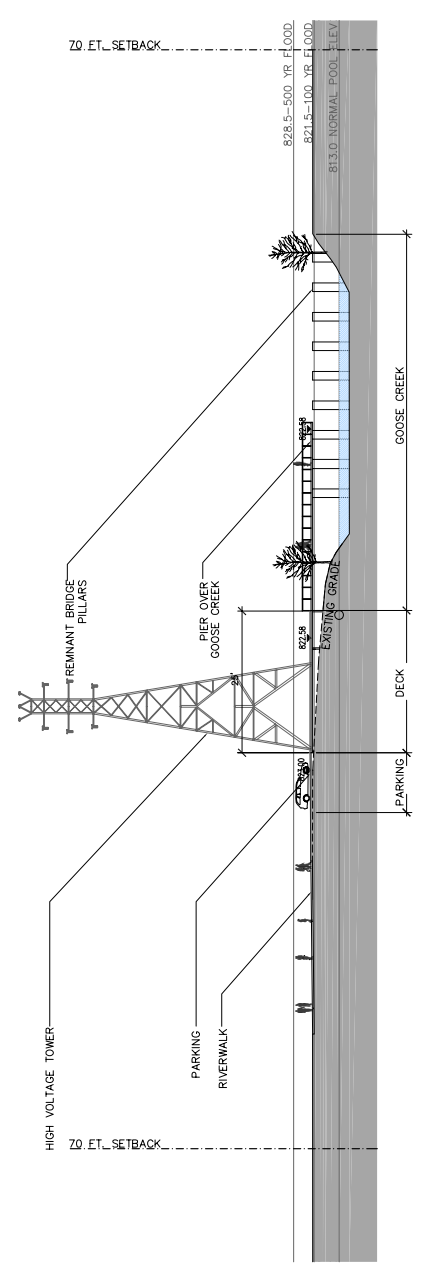

01 GOOSE CREEK PIER
 SCALE: 1"=20'

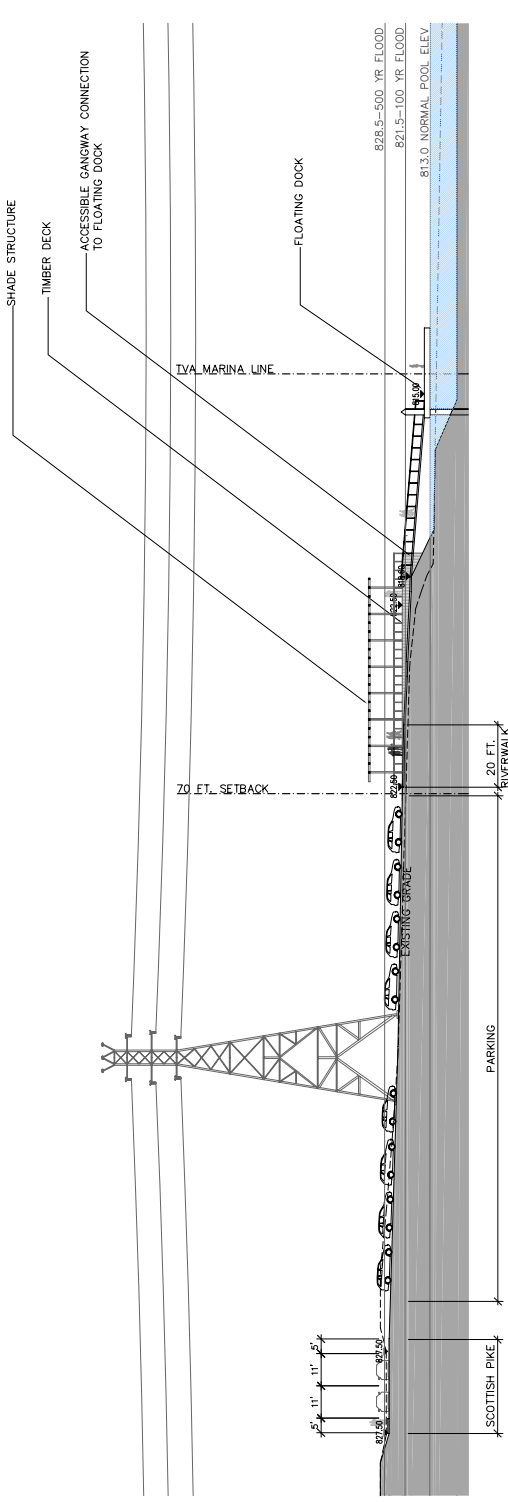

02 GOOSE CREEK LANDING
 SCALE: 1"=20'