



CITY OF KNOXVILLE

MADELINE ROGERO, MAYOR

SUTTREE LANDING PARK AND WATERFRONT DRIVE

PUBLIC MEETING  
PRESENTATION AND QUESTION & ANSWER PERIOD

WEDNESDAY, NOVEMBER 6, 2013

# SUTTREE LANDING PARK AND WATERFRONT DRIVE

## DESIGN AND CONSTRUCTION SERVICES TEAM

- |                                       |                                |
|---------------------------------------|--------------------------------|
| ▶ CIVIL ENGINEER/LEAD CONSULTANT      | CANNON & CANNON, INC.          |
| ▶ CIVIL ENGINEER - ROADWAY            | VAUGHN & MELTON, INC.          |
| ▶ LANDSCAPE ARCHITECT - PARK          | BENEFIELD RICHTERS             |
| ▶ LANDSCAPE ARCHITECT - STREETScape   | C R J A                        |
| ▶ ARCHITECT - PAVILION & BOATHOUSE    | STUDIO 4 DESIGN                |
| ▶ MECHANICAL/ELECTRICAL ENGINEER      | FACILITIES SYSTEMS CONSULTANTS |
| ▶ STRUCTURAL ENGINEER                 | CHAD STEWART & ASSOCIATES      |
| ▶ ENVIRONMENTAL/GEOTECHNICAL ENGINEER | S&ME, INC.                     |



FT LOUDOUN LAKE  
TENNESSEE RIVER

PHASE IB

WATERFRONT DRIVE

PHASE 1A

WATERFRONT DRIVE

DIXIE STREET

WATERFRONT DRIVE

PHASE 1C

LANGFORD AVE

## PHASE 1A

OPEN BIDS – JAN 2014  
CONSTRUCTION – APR 2014

BARBER STREET

DAVENPORT ROAD

POUGH BOTTOM STREET

SEVIER AVE

PHASE II



FT LOUDOUN LAKE  
TENNESSEE RIVER

PHASE 1B

WATERFRONT DRIVE

PHASE 1A

WATERFRONT DRIVE

DIXIE STREET

LANGFORD AVE

PHASE 1C

WATERFRONT DRIVE

POUGH BOTTOM STREET

SEVIER AVE

PHASE 2

## PHASE 1B

OPEN BIDS – APR 2014  
CONSTRUCTION – JUL 2014

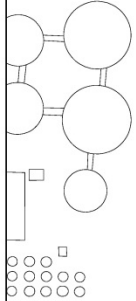

DAVENPORT ROAD

BARBER STREET

BARBER STREET





FT LOUDOUN LAKE  
TENNESSEE RIVER

PHASE IB

WATERFRONT DRIVE

PHASE IA

WATERFRONT DRIVE

DIXIE STREET

WATERFRONT DRIVE

PHASE IC

LANGFORD AVE

## PHASE 1C

OPEN BIDS – AUG 2014  
CONSTRUCTION – NOV 2014

BARBER STREET

POUGH BOTTOM STREET

SEVIER AVE

PHASE II



FT LOUDOUN LAKE  
TENNESSEE RIVER

PHASE IB

WATERFRONT DRIVE

PHASE IA

WATERFRONT DRIVE

WATERFRONT DRIVE

PHASE IC

LANGFORD AVE

PHASE 2

OPEN BIDS – DEC 2015?

BARBER STREET

DIXIE STREET

BARBER STREET

POUGH BOTTOM STREET

DAVENPORT ROAD

SEVIER AVE

PHASE II

FORT LOUDOUN LAKE  
TENNESSEE RIVER

FORT LOUDOUN LAKE  
TENNESSEE RIVER

FORT LOUDOUN LAKE  
TENNESSEE RIVER

- Phase 1 Construction
- Phase 2 Construction
- Phases 1 & 2 Construction

100' 0' 100' 200' 300'  
GRAPHIC SCALE

# SUTTREE LANDING PARK ROADWAY IMPROVEMENTS PHASING SITE PLAN NOVEMBER 6, 2013





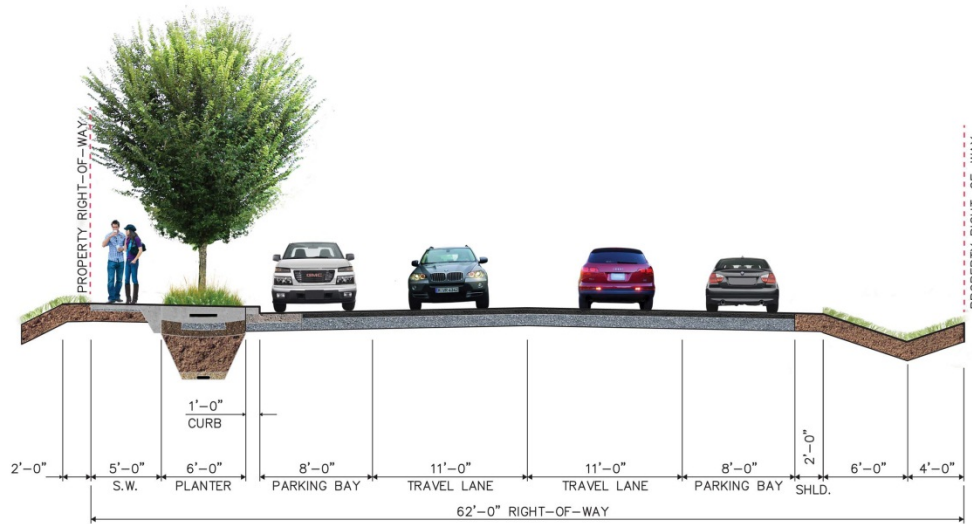

WATERFRONT DRIVE LOOKING EAST  
FROM STA. 11+69.58 TO STA. 28+67.28

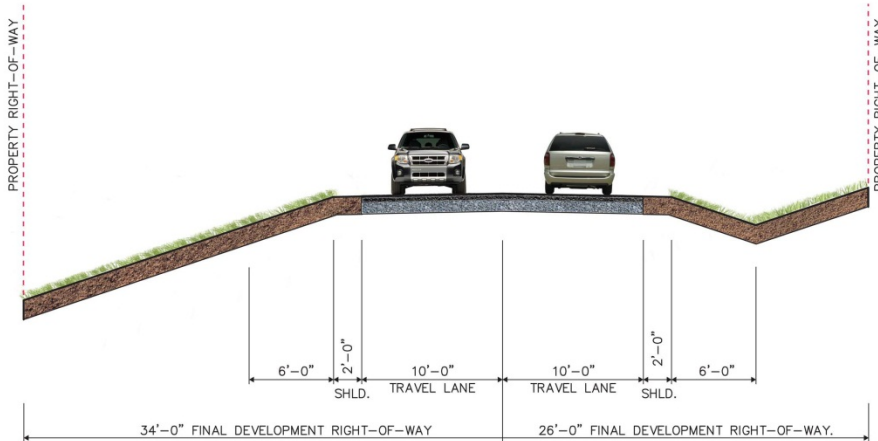

TEMPORARY TYPICAL: FOGGY BOTTOM ROAD LOOKING SOUTH  
FROM WATERFRONT DRIVE TO PHILLIPS AVENUE  
(SEE. PROP. LAYOUT FOR TRAFFIC CIRCLE AND ROUNDABOUT)  
FROM STA. 10+73.00 TO STA. 12+35.50

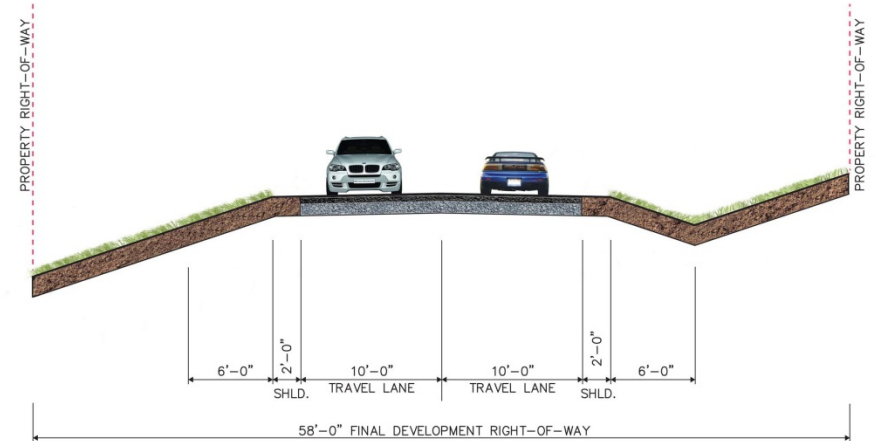

TEMPORARY TYPICAL: DIXIE STREET LOOKING SOUTH  
FROM STA. 10+19.00 TO STA. 12+39.50

SUTTREE LANDING PARK  
ROADWAY IMPROVEMENTS PHASE 1A  
ROADWAY SECTIONS NOVEMBER 6, 2013





SCALE: 1" = 50'

0' 25' 50' 100'

N.



11.01.2013 © The Benefield-Richters Company

# SUTTREE LANDING PARK: KNOXVILLE SOUTH WATERFRONT





RIVER WALK

DECORATIVE  
PAVING

RUNNING  
PATH

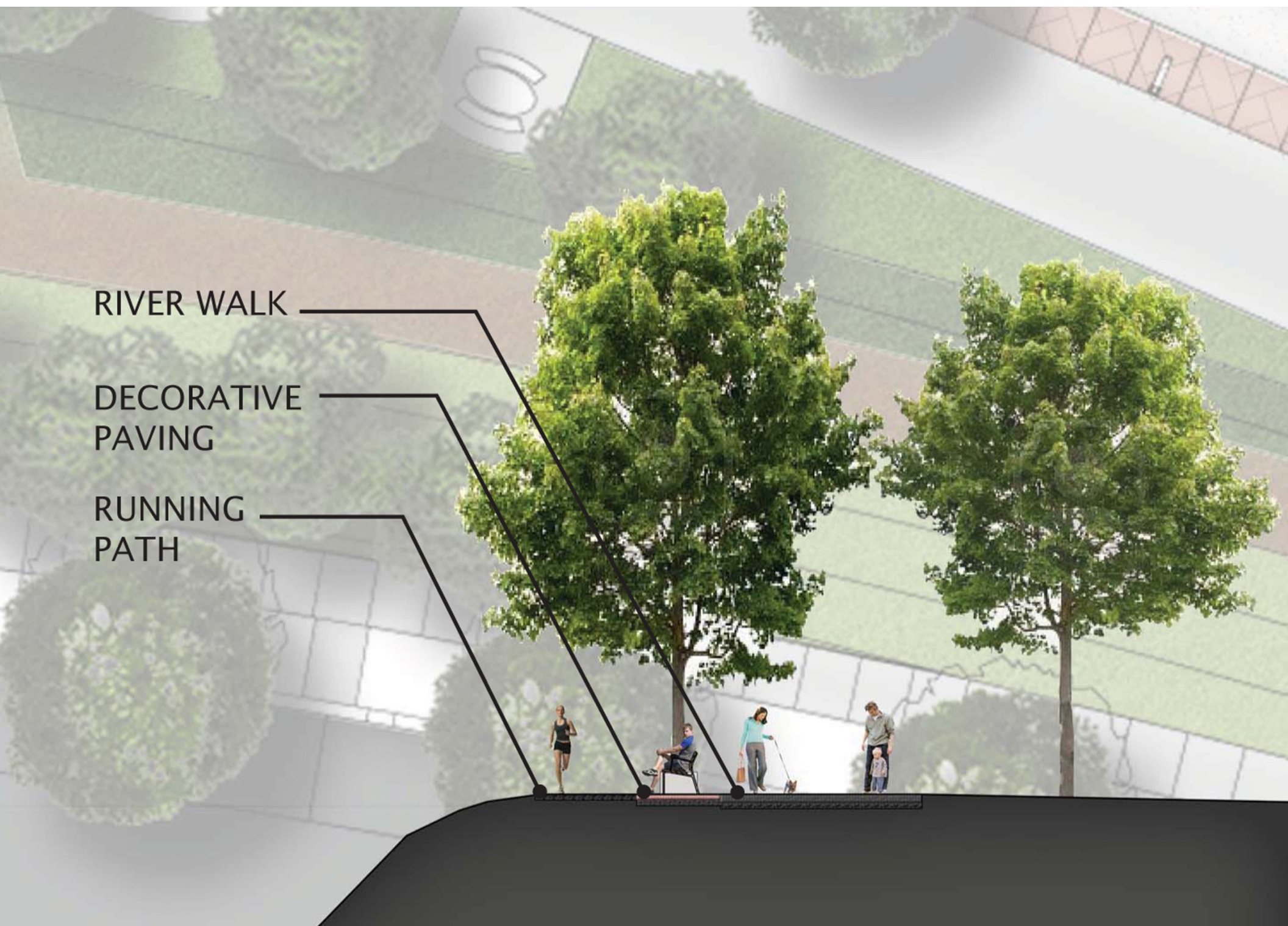





01



02



03



04



05



06



07

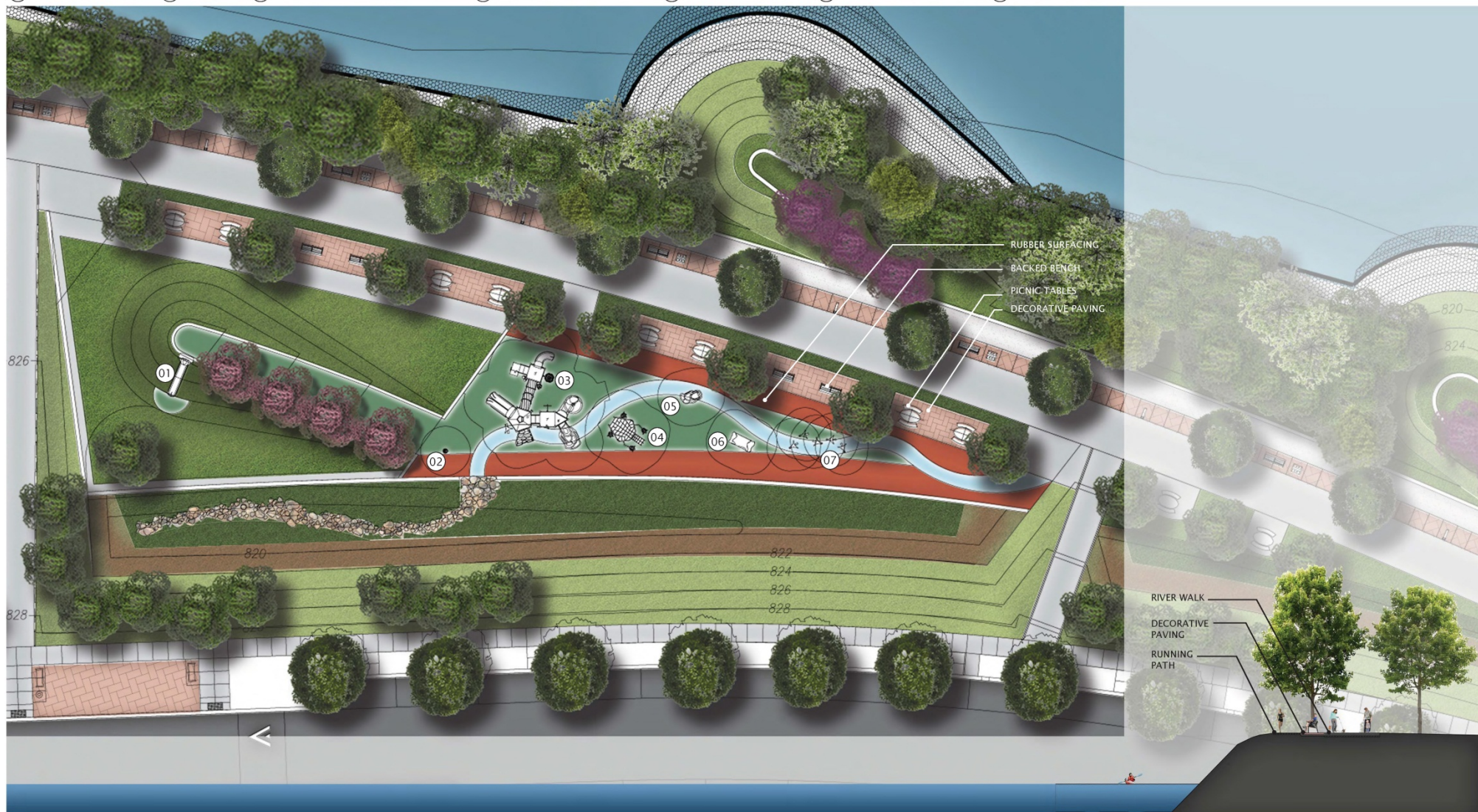

SCALE: 1" = 10'



SCALE: 1/8" = 1'-0"

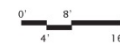

# SUTTREE LANDING PARK: KNOXVILLE SOUTH WATERFRONT



Cannon&Cannon, Inc.  
Consulting Engineers • Field Surveyors

**benefield · richters**  
architecture + planning

11.01.2013 © The Benefield Richters Company

# Graphic Legend

- Private
- Public
- Service

- 1 Bleachers
- 2 Covered Patio
- 3 Concessions
- 4 Mechanical
- 5 Vestibule
- 6 Overlook
- 7 Women's Restroom
- 8 Janitor's Closet
- 9 Men's Restroom
- 10 Kayak Lockers
- 11 Dock Ramp
- 12 Dock
- 13 Kayak Launch Ramp

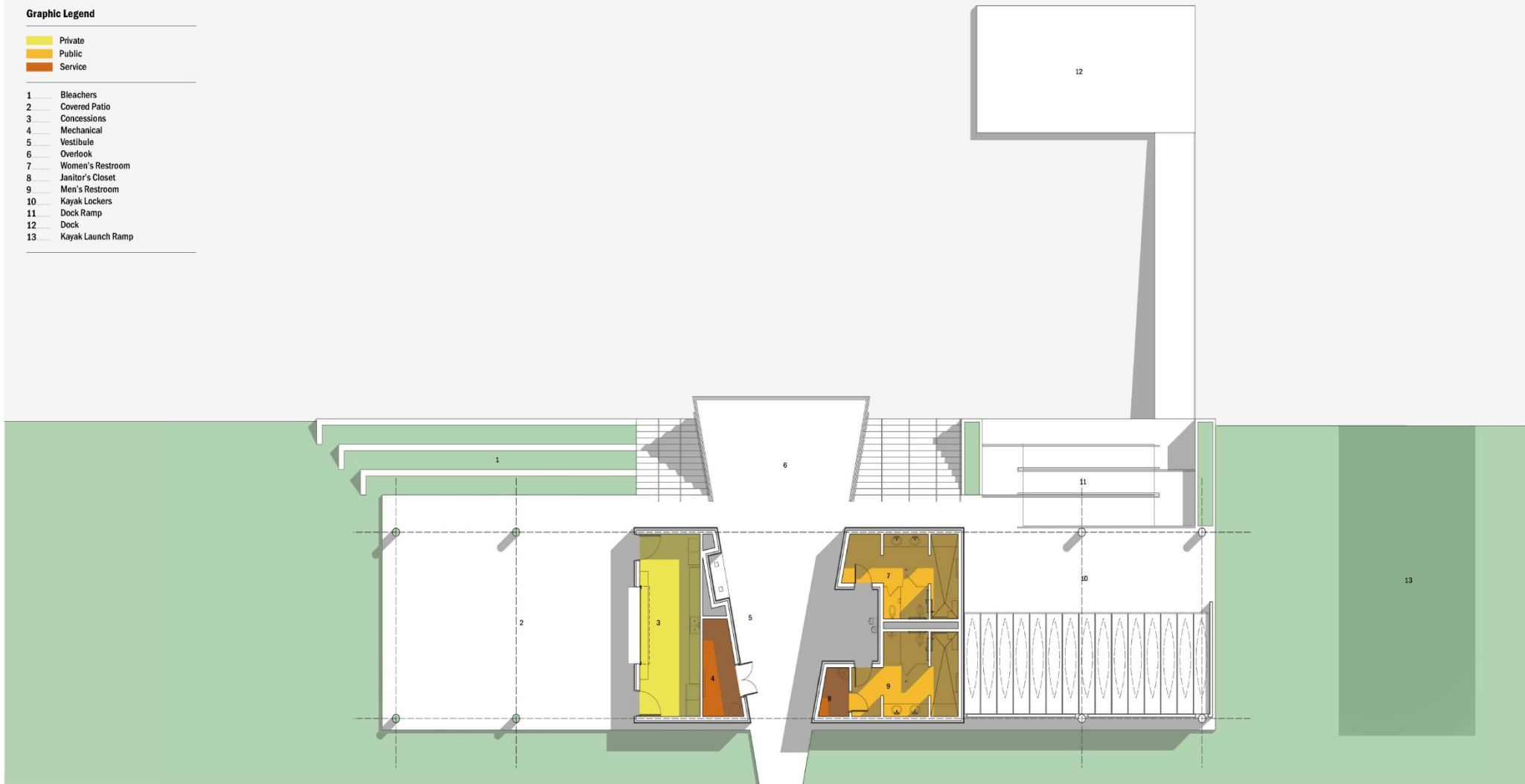

## Pavilion & Boathouse at Suttree Park Knoxville, Tennessee

These drawings are for communication of design intent only  
and are not intended for construction or fabrication.

**STUDIO**  
**FOUR**  
**DESIGN** Inc.











# Questions or Comments?

---

### **For More Information, Contact:**

---

Ms. Dawn Michelle Foster,  
Deputy Director of Redevelopment  
City of Knoxville  
400 Main St., Room 655  
Knoxville, TN 37902  
(Tel) 865-215-2607  
[dmfoster@cityofknoxville.org](mailto:dmfoster@cityofknoxville.org)

